

STAINLESS STEEL
**ENCLOSED BASE CABINETS
 with DRAWERS**

**Both feature fully enclosed 30" NSF Drawers
 5" Backsplash*



Hinged Doors



Sliding Doors

FEATURES:

5" SPLASH is furnished with a 1 5/8" sanitary rolled rim on the front side and 1 5/8" square bend edges on the 2 sides and a 5" splash with a 1" return on the rear side.

CONSTRUCTION:

All TIG welded. Exposed areas finished to match adjacent surfaces.

Entire Top is mechanically polished to a satin finish and is sound deadened.

UNIT-BODY DESIGN sides, back and shelf are welded to form a single rigid structure.

MATERIAL:

TOP is 14 gauge stainless steel type "304" series with galvanized understructure.

BODY is 18 gauge stainless steel type "430" series.

LEGS and 1" adjustable bullet feet are Stainless Steel.

ACCESSORIES

Model #	Description	Qty.
TA-105	Mod. to 24" Width	
TA-110	Mod. to 36" Width	
TA-14	Drawer Lock	
TA-46	Door Locks	
NS-2015	NSF Drawer	20x15x5"
NS-2020	NSF Drawer	20x20x5"

HINGED DOOR CABINET

MODEL #	LENGTH	# DRAWERS	WEIGHT
HDRC-305	60"	2	300 Lbs.
HDRC-306	72"	2	360 Lbs.
HDRC-307	84"	3	420 Lbs.
HDRC-308	96"	3	540 Lbs.
HDRC-3010	120"	4	600 Lbs.

SLIDING DOOR CABINET

MODEL #	LENGTH	# DRAWERS	WEIGHT
SDRC-305	60"	2	300 Lbs.
SDRC-306	72"	2	360 Lbs.
SDRC-307	84"	3	420 Lbs.
SDRC-308	96"	3	540 Lbs.
SDRC-3010	120"	4	600 Lbs.

DETAILS and SPECIFICATIONS

HDCR Series

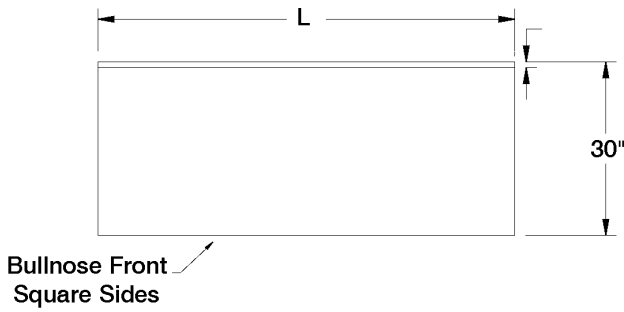

HINGED DOOR CABINET

MODEL #	LENGTH	# DRAWERS	WEIGHT
HDCR-305	60"	2	300 Lbs.
HDCR-306	72"	2	360 Lbs.
HDCR-307	84"	3	420 Lbs.
HDCR-308	96"	3	540 Lbs.
HDCR-3010	120"	4	600 Lbs.

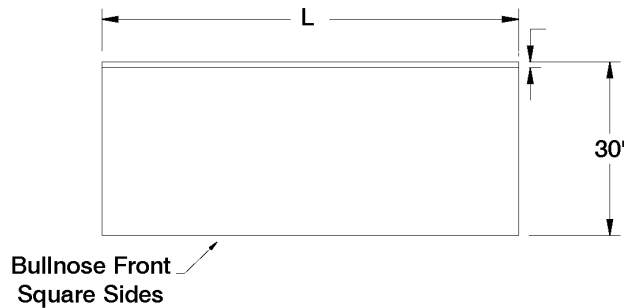
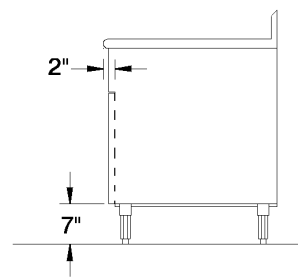
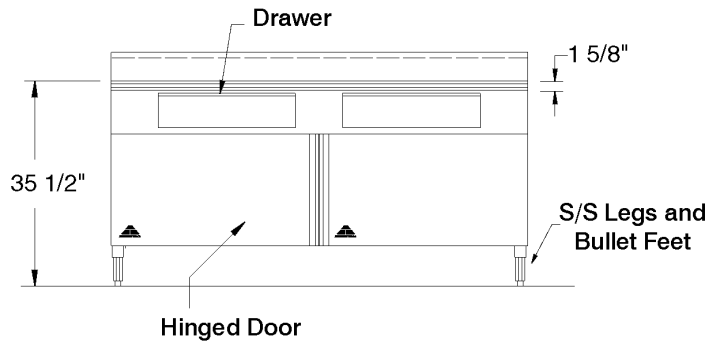

SLIDING DOOR CABINET

MODEL #	LENGTH	# DRAWERS	WEIGHT
SDRC-305	60"	2	300 Lbs.
SDRC-306	72"	2	360 Lbs.
SDRC-307	84"	3	420 Lbs.
SDRC-308	96"	3	540 Lbs.
SDRC-3010	120"	4	600 Lbs.

