



CleanAir Solutions, Inc.

The Cleanroom Specialists

**Puzzled by
your latest
drop in yield?
Let us help...**

ENTER



Copyright © 2002 CleanAir Solutions, Inc.

Moving toward the future....

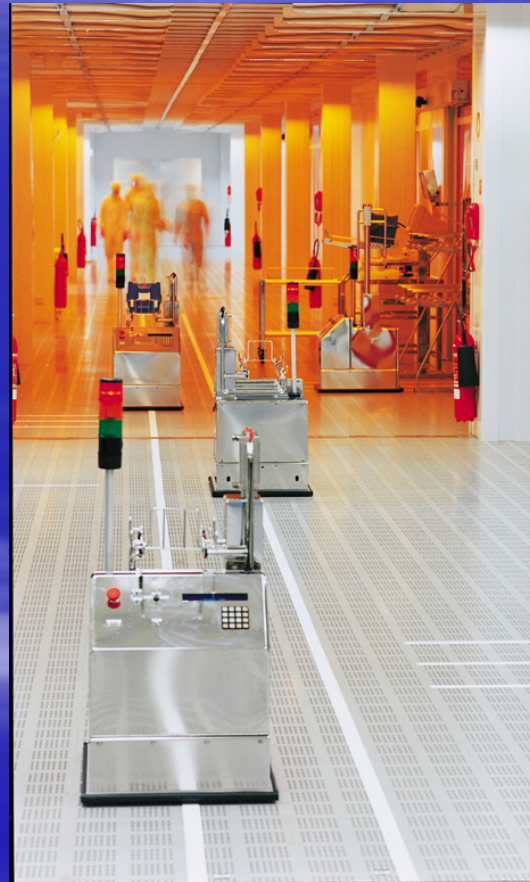

With a State-of-the Art



**Class 100 Modular Cleanroom System
by CleanAir Solutions, Inc.**

Construction begins

2008



Load Bearing Wall Systems

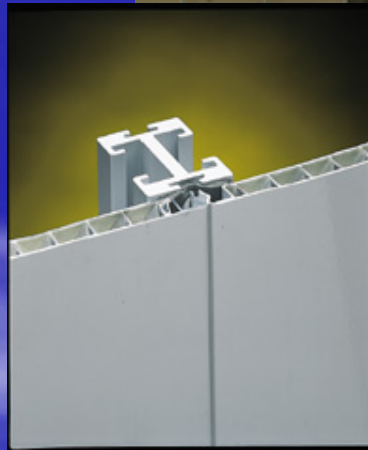

Support overhead trusses to provide clear-span interior

Fan Filter Modules

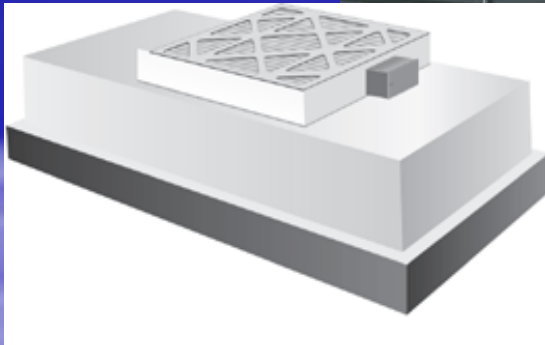

Will lay inside the 2" gasket grid below the plenum lid to create a large mixer box above the room.

HVAC Supply Ducts



Will evenly disperse the conditioned air from the dedicated HVAC system to maintain proper cooling and positive pressure inside the cleanroom.

Cleanroom Curtains



**ESD Safe Divider curtain
will separate the Class
10,000 and 1,000 areas**



Pass-Thru Cart



Allows spare parts to be passed into the cleanroom without jeopardizing the integrity of the environment while maximizing the engineers time.

Auto Sliding Doors



Offer hands-free transfer between the Class 100 and Class 1,000 cleanroom areas.

Re-circulating Air Flow

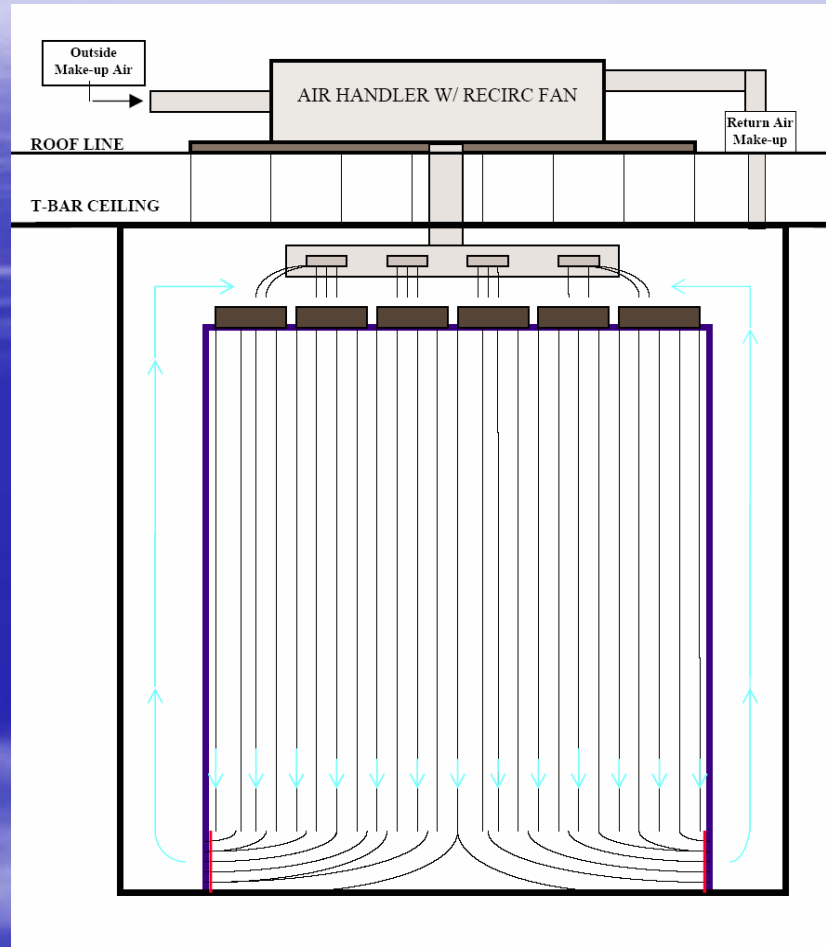

Room-in-a-room design, offers a completely self-contained environment

Drawing example Class 100 Cleanroom

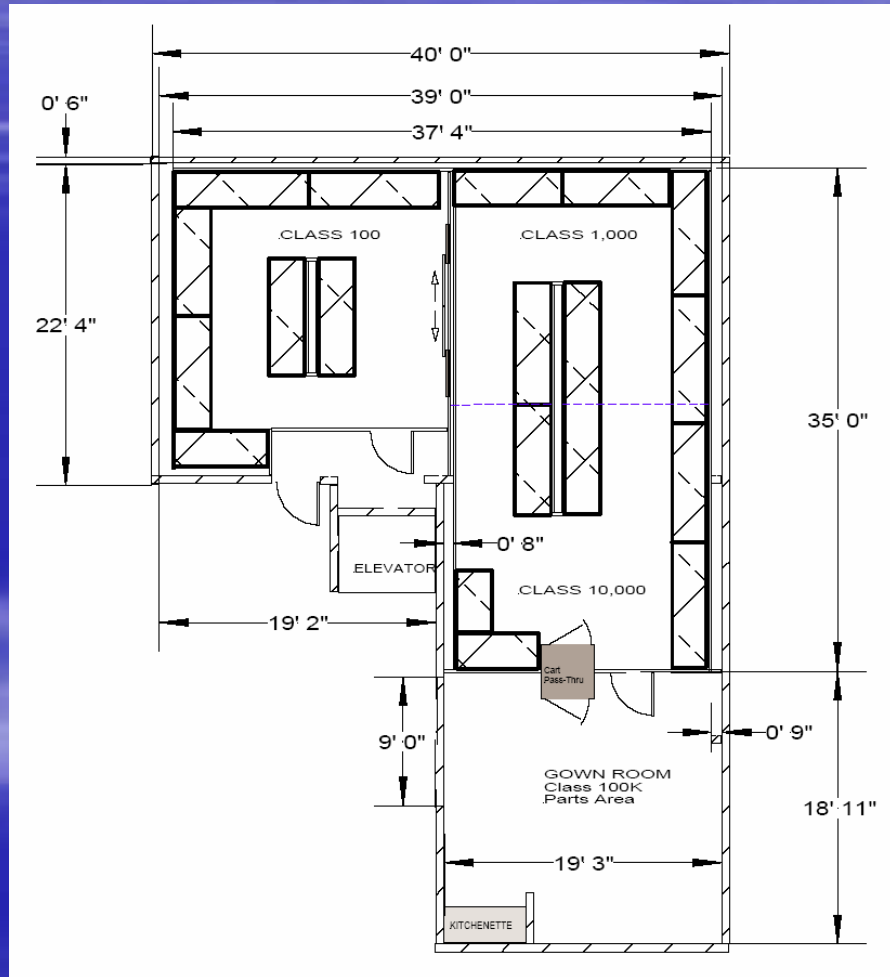

Reflective-View

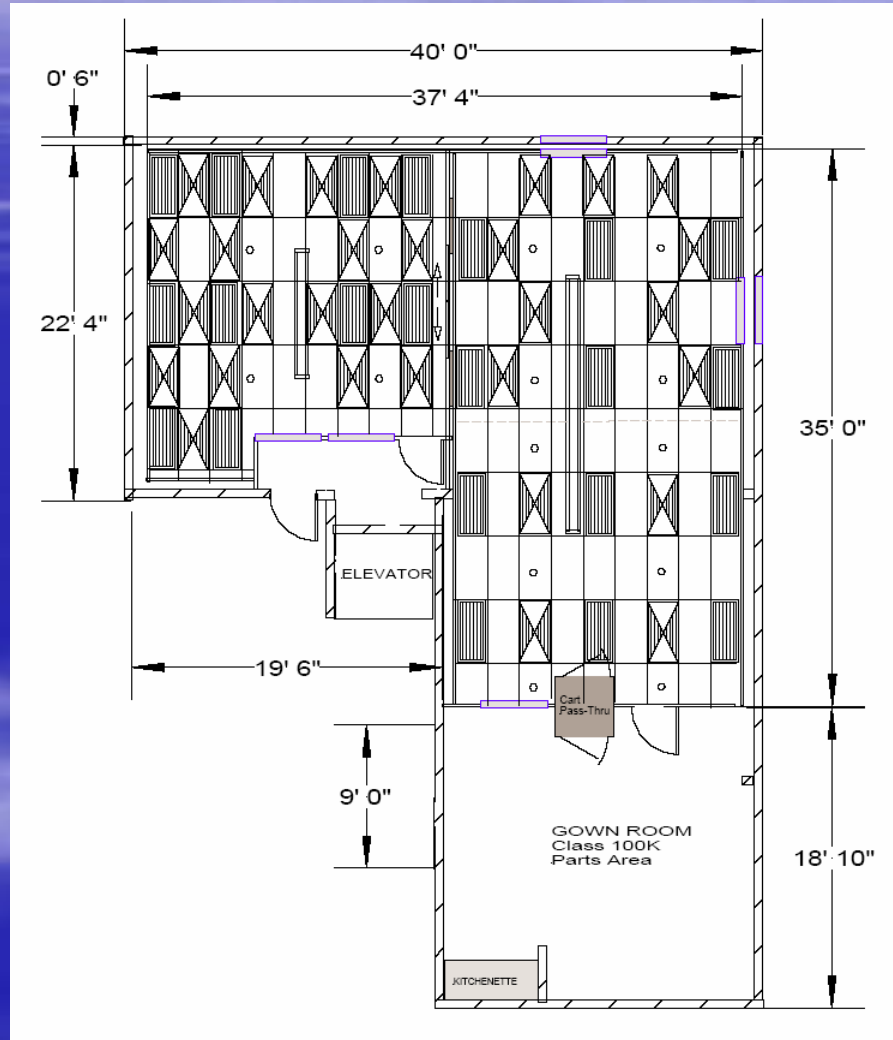

Finished ABC Cleanroom



Completion March 2007